

"Quick Quote" - Step One

Prepare a simple drawing for each room where you want to install Heat Profile skirting. You don't need to be Picasso, a rough sketch will do!

Show all walls, doors, full height windows (if any), furniture which is fixed in the room and all other obstacles where the skirting cannot be installed.

The example below contains two doors and no floor level obstacles.

Name the room and number each wall to identify it later. Write the information on the Panel Calculator Form (print it out if you haven't already done so - PRINT PAGE 4 OUT).

Measure the walls and record each wall length in the column provided on the Panel Calculator Form.

Make sure you Indicate the system - Gas or Electric

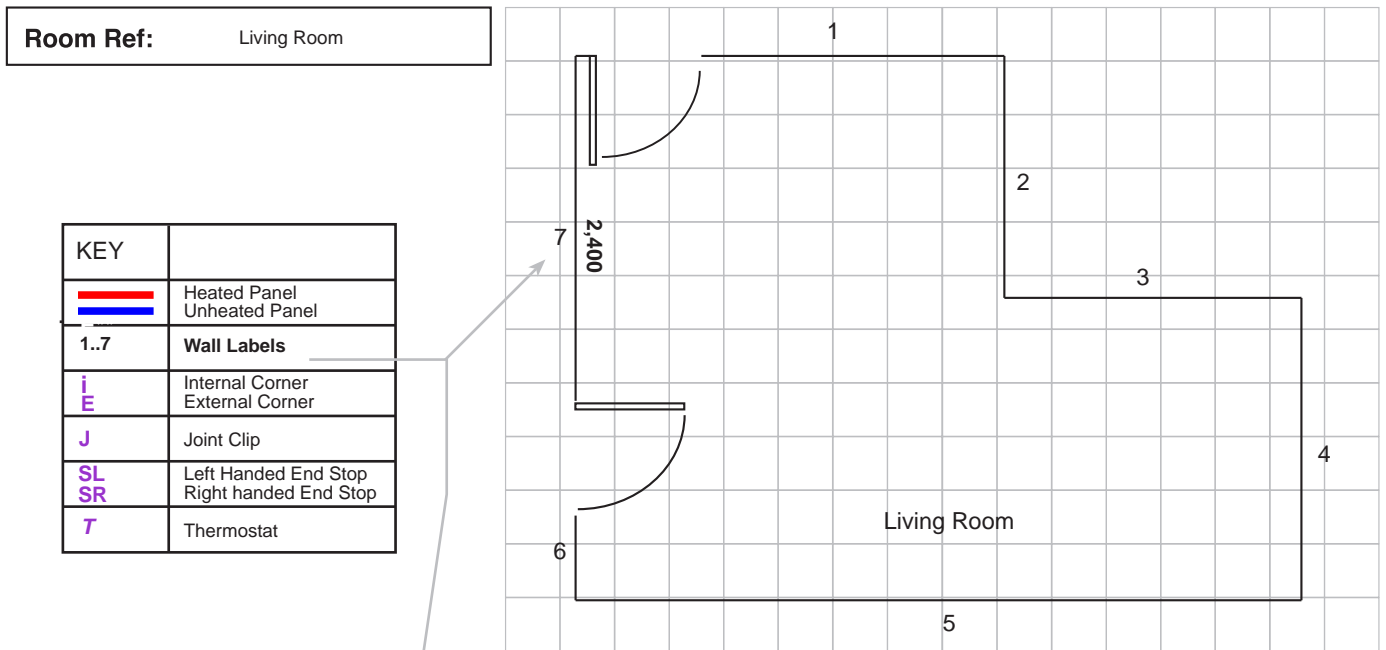

Your Panel Calculator Form should now look like this (for our example above):-

Panel Calculation Form

Wall Number	Wall Length (mm)	Number of Internal Corners	Deductions	Panel Length Required	Panel Code	
1	2,350					
2	2,000					
3	2,100					
4	1,800					
5	5,450					
6	600					
7	2,400					
Room Total						

"Quick Quote" - Step Two

Next, take your sketch and add the symbol "i" at all internal corners and "E" at all external corners (see our example drawing below). This is to show where internal and external corner covers will be fitted.

Add the symbols "SL" or "SR" where a section of skirting ends, ie. at doors and other obstacles. Note: "SL" denotes an end stop at the left-hand end of the skirting and "SR" denotes an end stop at the right-hand end. This information will be used to complete the order form and will be helpful for installation.

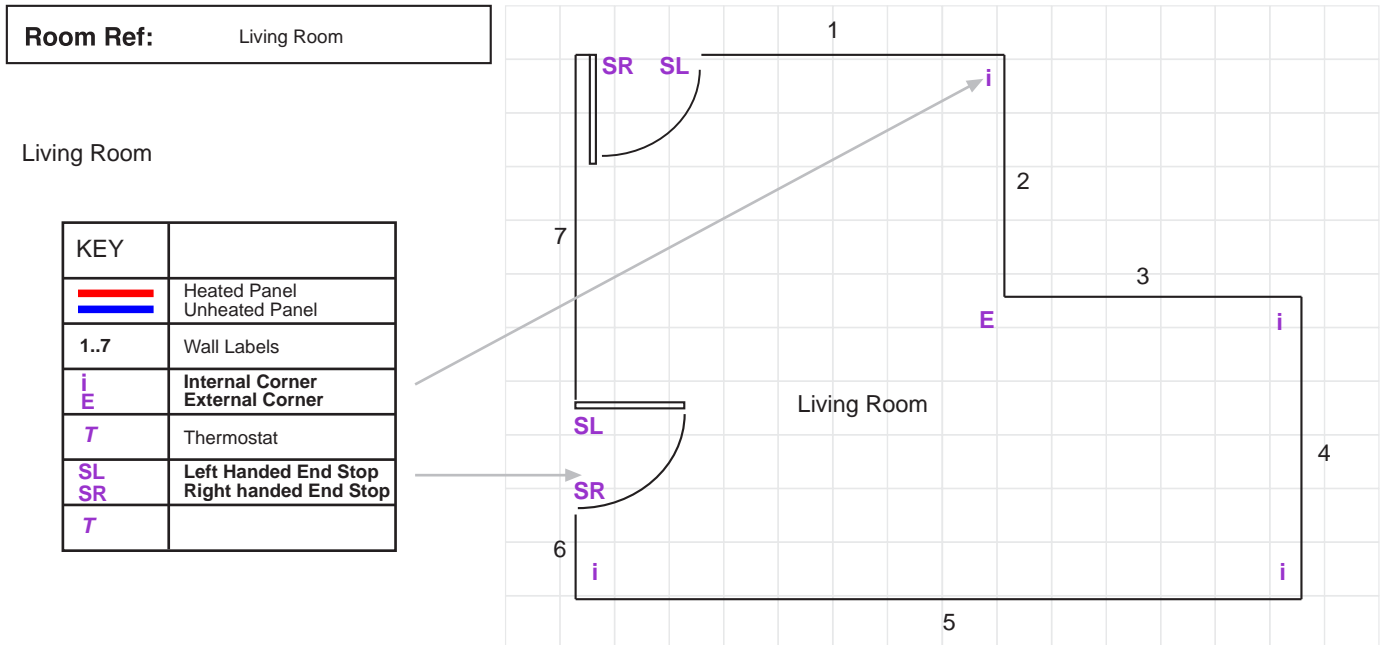

On the Panel Calculator Form, in the column provided, record the number of internal corners that are attached to each individual panel. Note: every internal corner counts for each panel even if it is attached to two panels.

Your completed Panel Calculator Form should now look like this (for our example above):-

Panel Calculation Form

Wall Number	Wall Length (mm)	Number of Internal Corners		Panel Length Required	Panel Code	
1	2,350	1				
2	2,000	1				
3	2,100	1				
4	1,800	2				
5	5,450	2				
6	600	1				
7	2,400	0				
Room Total						

"Quick Quote" - "Special Corners", "Curved Panels" & Threshold Heating

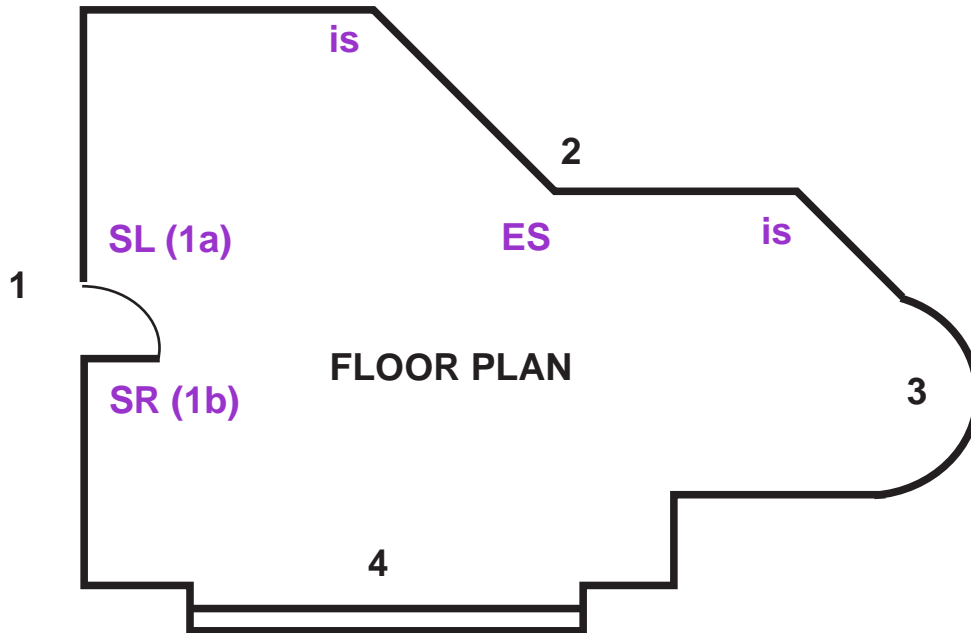

The solution to every heating need

This plan demonstrates some typical features that can be found in a room.

The text below explains how best to use HeatProfile in these situations.

1. End Stops

These are generally required where the skirting comes to a logical end, i.e. doorways. However, this is not always the case as HeatProfile skirting can be buffed up against a door frame architrave providing that the architrave depth is greater than 28mm. Alternatively a plinth block can be employed, replacing at least the bottom 15cm of the architrave. Ideally this should be a minimum of 28mm deep. It should be noted that there are two types of end stop, left hand (1a) and right hand (1b). The correct type should be specified when ordering.

2. Special Corners

Where any two walls meet at an angle that is not 90 degrees, a special corner cover will be required. This should be shown on the plan as (is) or (ES) depending on whether it is an Internal or External Special corner. These corner covers are made to special order so either the exact angle or a template of the corner will be required from you so that the cover can be accurately manufactured (See * below).

3. Special Curved Panels

Some rooms may have a curved wall that needs to be heated. HeatProfile can be supplied in curved sections to special order. The exact radius and curved length of the wall will be required from you so that accurate fabrication is ensured. Alternatively a template should be provided (See * below).

4. Threshold Heating

Sometimes there is a requirement to heat the area in front of a patio door opening in order to reduce draught and condensation. This can be achieved by fitting a HeatProfile panel flat on the floor in front of the opening. It can be fitted in a shallow recess and finished flush with the floor or mounted directly on the floor, buffed against the doorframe and finished proud as required. HeatProfile is very strong and can easily withstand foot traffic. Various tread materials are available to match the room decor. (Contact the HeatProfile [help line: 01483 537000](tel:01483537000) for further information).

* Special non-standard corners and curved pieces are fabricated to order. The prices of these will vary depending on the quantity ordered and the amount of labour and material involved. For more information, please call the HeatProfile [help line: 01483 537000](tel:01483537000) or [email: sales@heatprofile.co.uk](mailto:sales@heatprofile.co.uk)

Mailing details



Architectural Heating

Your next step to complete the quote is to send your completed forms and room plans to HeatProfile for verifying, once verified HeatProfile will then advise on delivery dates and charges. Should you have any queries please contact HeatProfile

HeatProfile Architectural Heating Ltd.

Horizon House
Wey Court
Mary Road
Guildford
Surrey
GU1 4QU

Tel.: 01483 537000
Fax: 01483 537500
E-mail: sales@heatprofile.co.uk

Title:

First Name(s):

Surname:

Company:

Position:

Daytime Telephone No:

Home Telephone No:

Address 1:

Address 2:

Address 3:

Address 4:

County:

Post Code:

E:Mail

Comments / Questions

- Posting Check List
- Panel Calculation forms
- Indicate -
- Gas
- Electric
- Mailing details

Your details will be treated as completely confidential and will not under any circumstances, be divulged to any third party